



Metallic Effect Enamel (V400MET)

Do you want to give a unique brilliance to surfaces and various objects? Are you an artist or enjoy DIY projects? Then this is the spray for you! Ideal for household materials, it dries quickly and acts deeply. The effects of gold and silver will amaze you!

METALLIC EFFECT ENAMEL - A metallic enamel that has a particular brightness that looks similar to a mirror. It is adhesive and can be used on any material that is not non-stick (Polyethylene, etc..). Ambro-Sol Leafing is designed for indoor/outdoor use to brighten different surfaces and objects such as frames, furniture, iron, vases, mask, cups, medals, Christmas ornaments, etc. It is dry to the touch approximately 30 minutes after use and its completely dry approximately 1 hour after application. It does not provide protection from abrasions. Once applied handle with care.



Directive 2004/42/CE: C.O.V.
Under category: Special finishing
Limit value COV: 840 g/Liter

FIELDS OF APPLICATION: Wood surfaces, metal surfaces as iron, aluminum, steel, glass and plastics. Apply at room temperature: Min.10°C – Max 35°C.

Technical specifications:

Quantity	400 ml
Box / Case	6 Pz.
Aspect	Tin-Plate can containing under pressure fluid
Chemical nature	Quick drying acrylic paints
Colour	Various
Odour	Characteristic of solvent
Relative density	At 20°C 0,72 ÷ 0,76 g/ml
Flash point	Und. 0° C extremely flammable
Writing on spray bottom	Barcode, Batch date, product name
Pressure	at 20°C 5,5 ± 0,5 bar
Pressure	at 50°C 8,0 ± 0,5 bar
Viscosity Ford cup	From 10" to 13"
Dry residual in spray	From 28% to 38%
Granulometry grindometer	Bottom Scale 0 a 2 Micron
Gloss	From 20 to 100 (Glossmeter angle 60°)
Thickness 1 coat	about 13 Micron
Thickness 3 coats	about 36 Micron
Resistance temperature	-10°C / +150°C (Peak 200° C)
Drying times:	Out dust 15 minutes
	Dry to touch 30 minutes
	Dry in depth 1 hour
Security cap child-proof patented	
Token and ring with color reference	
Is possible have different type of actuators for various effects and employ	
Check the color and/or product type on the cap or the bottom of the can.	

Advice for use: clean accurately the surface to be treated, the surface must be completely dry. If you want to apply the product on plastic surface it is advisable to use an anchor primer for plastics (V400PRIMER.2). For mirror/chrome products (V400MET.3 e V400MET.5) if you apply more than once on the same surface, the final mirror effect is more evident.

HOW TO USE:

- Vigorously shake the can for at least 1 minute, until you hear the inner marbles move freely. It is also suggested to occasionally shake the cylinder even during use;
- Carefully clean the surface before application;
- Test in a hidden area to verify compatibility of the surface with the paint.

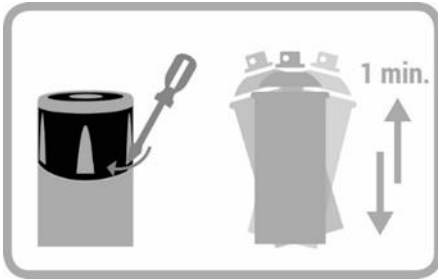

Remove the secure seal on the cap, to open the spray



**EROGATORE PRODOTTI
VERNICIANTI NERO/BIANCO**
BLACK/WHITE PAINTING
PRODUCTS ACTUATOR

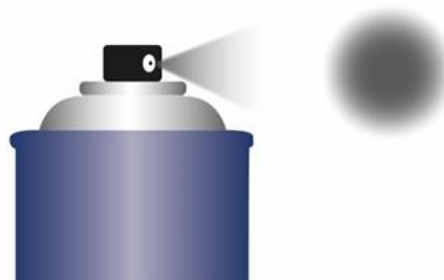

- **Erogazione:Lineare**
Dispensing:Linear
- **Quantità prodotto erogato:Media**
Quantity product dispensed:Medium
- **Tipo di erogazione:Cono medio**
Dispensing type:Medium cone
- **Tipo di spruzzo:Nebulizzato**
Spray type:Nebulized

SPRAY:

- Apply a first hand / coat light to improve coverage and adherence, to reduce the possibility of dropping. Apply from a distance of 20-30 cm;
- After a few moments apply a second horizontal hand/coat immediately followed by a third vertical hand / coat;
- Let dry a few minutes;
- After use, it's advisable to spray for 2/3 seconds with the spray upside down, to avoid the block of the actuator;
- After 24h, proceed with the normal use of painted piece.

MODALITY OF STORAGE

Before using: stock the product in a dry location and don't stock it with a temperature under 5°C and over 45°C, after the use, keep containers closed. In the original package, the product can be conserved for 24 months (warranty). The product doesn't expire.

After the first usage: conserve in a fresh and dry location, away from hot spring. Keep out of reach of children.

This information, even if reliable, must be considered only approximate. We are not responsible for the wrong use of the product, or the violation of any license. Before using, the users should verify the suitability of the product for its specific use.

BEFORE USE, CONSULT THE SAFETY DATA SHEET OF THE PRODUCT